

# Aintree

RACECOURSE

# UNIQUE EVENTS

AN ICONIC VENUE







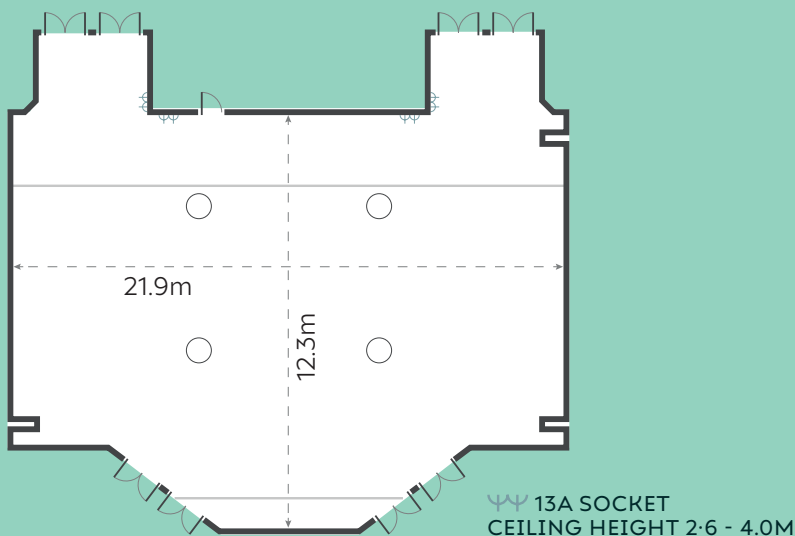

QUEEN MOTHER STAND:

## VALENTINE SUITE

The Valentine Suite was named after one of the Grand National fences originally known as Second Brook, but was renamed when a horse named Valentine was reputed to have jumped hind legs first in 1840. Located within the Queen Mother Stand, the Valentine Suite offers conference, meeting and banqueting space for up to 200 delegates, with stunning views across the racecourse.

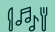

### Stats at a glance...

	THEATRE	200
	BOARDROOM	60
	CABARET	100
	CLASSROOM	80
	DINNER	200
	DINNER DANCE	160
	U SHAPE	-
	RECEPTION	200

CONTACT US ON: 0151 522 2922

NORTHWESTEVENTS@THEJOCKEYCLUB.CO.UK

