

PRINCESS ROYAL STAND

WALLIS SUITE

Tommy Wallis was closely involved with the acquisition of Aintree in 1983 by the Aintree Racecourse Charitable Trust and was instrumental in ensuring the Grand National and its home were saved for posterity. The Wallis Suite is perfect for large board meetings of up to 50 attendees and receptions for up to 280.



THEATRE

230



BOARDROOM

50



CABARET

175



CLASSROOM

90



DINNER

280



DINNER DANCE

250



U SHAPE

-



RECEPTION

250

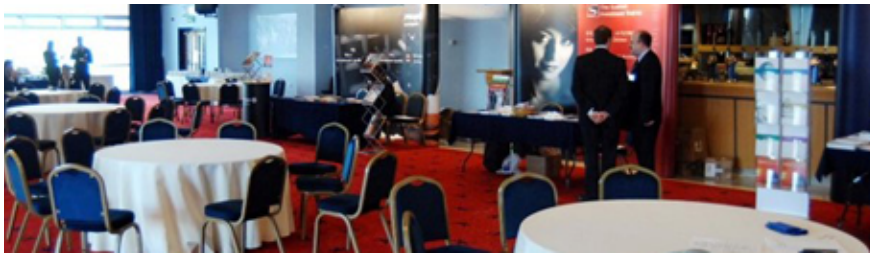

13A SOCKET

USEABLE SPACE DIMENTIONS

3 PHASE POWER

(NO.) FLOOR SOCKETS

FLOOR PLAN

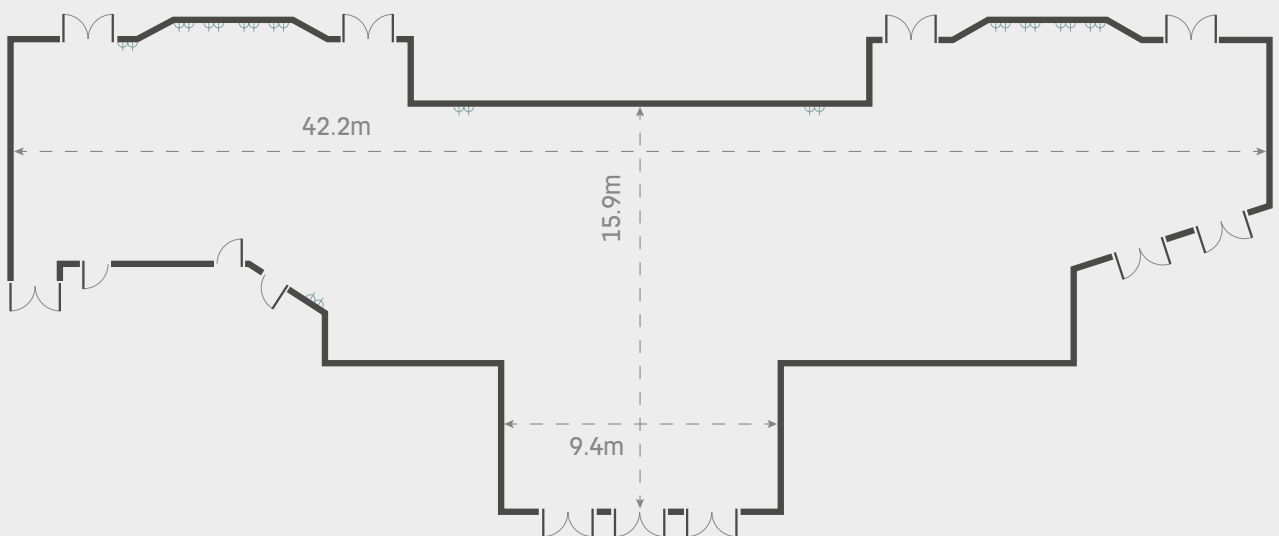

CONTACT US ON: 0151 522 2922 | NORTHWESTEVENTS@THEJOCKEYCLUB.CO.UK