

Haydock Park

RACECOURSE

UNIQUE EVENTS

AN ICONIC VENUE







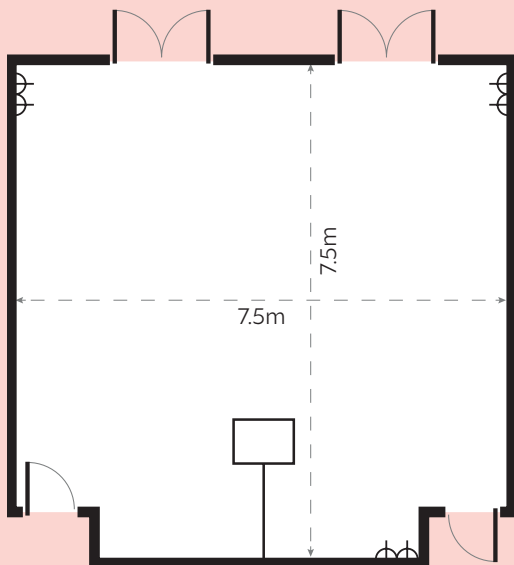

TOMMY WHITTLE STAND:

DOUBLE BOX

Located within the Tommy Whittle Stand, each double box boasts stunning views overlooking the racecourse and can cater for 24 guests for private dinner or conference.

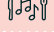

Stats at a glance...

	THEATRE	30
	BOARDROOM	20
	CABARET	24
	CLASSROOM	-
	DINNER	30
	DINNER DANCE	-
	U SHAPE	-
	RECEPTION	-

CONTACT US ON: 01942 402623
NORTHWESTEVENTS@THEJOCKEYCLUB.CO.UK

