

Cheltenham

RACECOURSE

UNIQUE EVENTS

AN ICONIC VENUE



MAIN GRANDSTAND:

ISTABRAQ







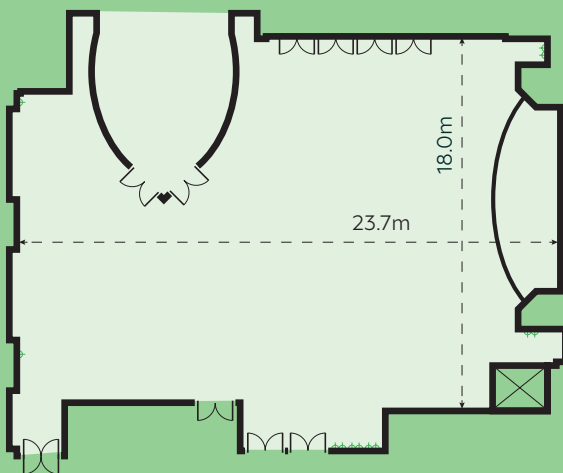

Istabraq is located above the Main Centaur, foyer and leads out on to The Centaur balcony so perfectly complements large events in The Centaur, as a dining area or a breakout space.

It can also be used as a small event space in its own right. It is a bright and light space with two sides of glass, overlooking a section of the Racecourse in one direction and the Stables and Centaur Bridge in the other.

13A SOCKET X 20
CEILING HEIGHT - 3M
AMP WITH CEILING
SPEAKERS & MIC INPUT
SCREEN & PROJECTOR
MUST BE BROUGHT IN
(NO HEAVY POWER)



Stats at a glance...

	THEATRE	120
	BOARDROOM	28
	CABARET	80
	CLASSROOM	-
	DINNER	-
	DINNER DANCE	-
	U SHAPE	-
	RECEPTION	450

CONTACT US ON: 01242 539538

CHELTENHAMEVENTS@THEJOCKEYCLUB.CO.UK

